

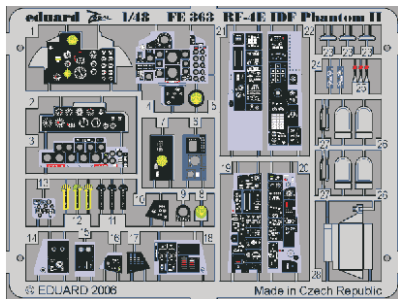

RF-4E IDF Phantom II

1/48 scale detail set for Hasegawa kit • sada detailů pro model Hasegawa 1/48

FE363



- ★ APPLY EXPRESS MASK AND PAINT BEFORE GLUING
POUŽIT EXPRESS MASK NABARVIT PŘED SLEPENÍM
- ☾ SYMMETRICAL ASSEMBLY
SYMETRICKÁ MONTÁŽ
- REMOVE
ODSTRANIT
- ▨ GRIND
OBROUSIT
- ⊘ DRILL HOLE
VRTÁT OTVOR
- ↪ BEND
OHNOUT
- ⊕ OPTION
VOLBA
- Ⓜ REPLACE
NAHRADIT

ORIGINAL KIT PARTS
PŮVODNÍ DÍLY STAVEBNICE

PHOTO-ETCHED PARTS
LEPTANÉ DÍLY

PARTS TO BE REMOVED
DÍLY K ODSTRANĚNÍ

FILL
TMELIT

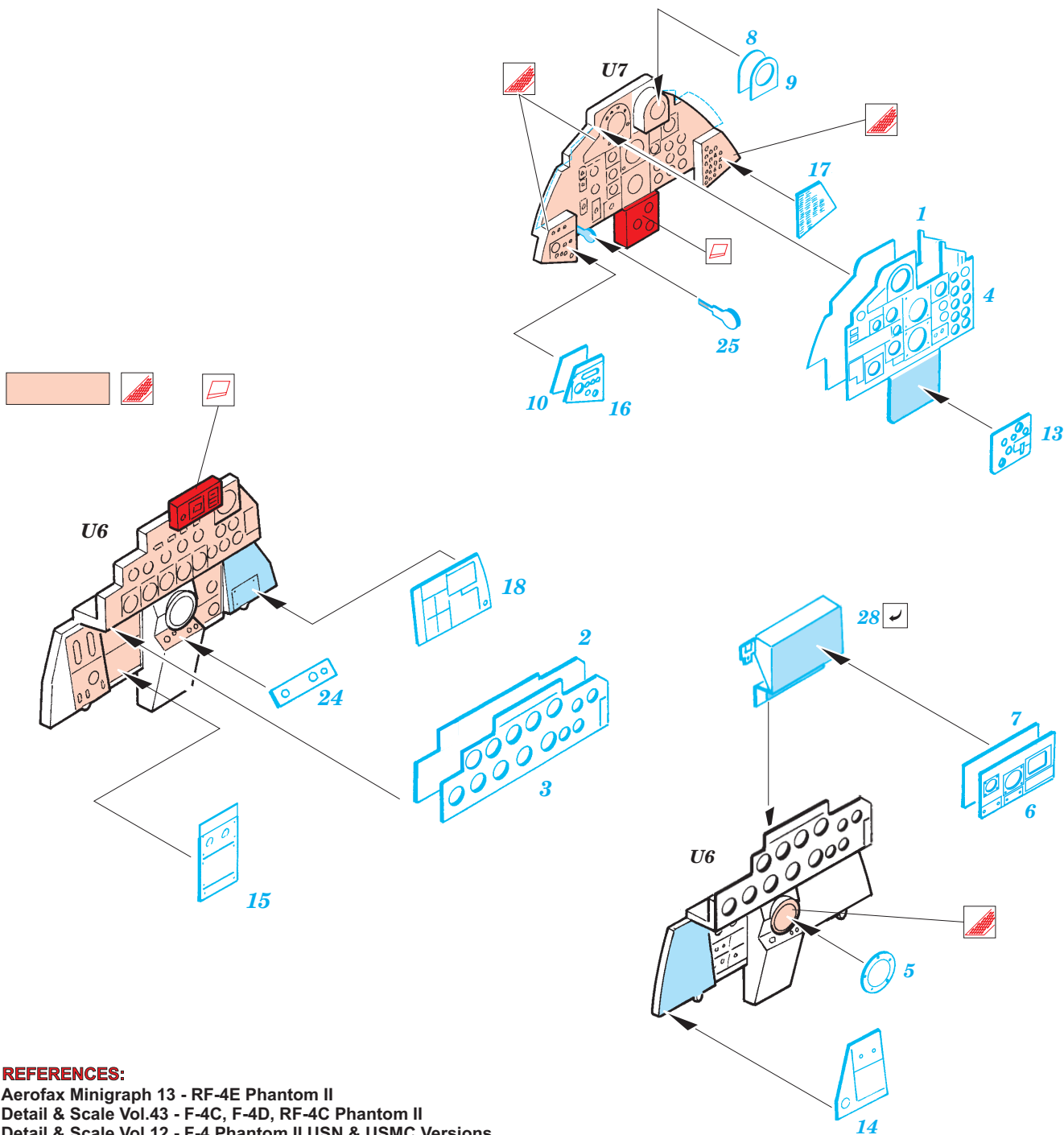

REFERENCES:

Aerofax Minigraph 13 - RF-4E Phantom II
Detail & Scale Vol.43 - F-4C, F-4D, RF-4C Phantom II
Detail & Scale Vol.12 - F-4 Phantom II USN & USMC Versions

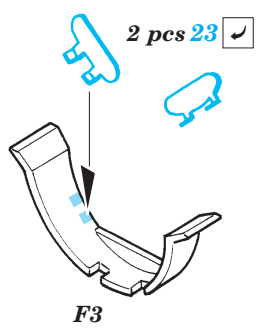
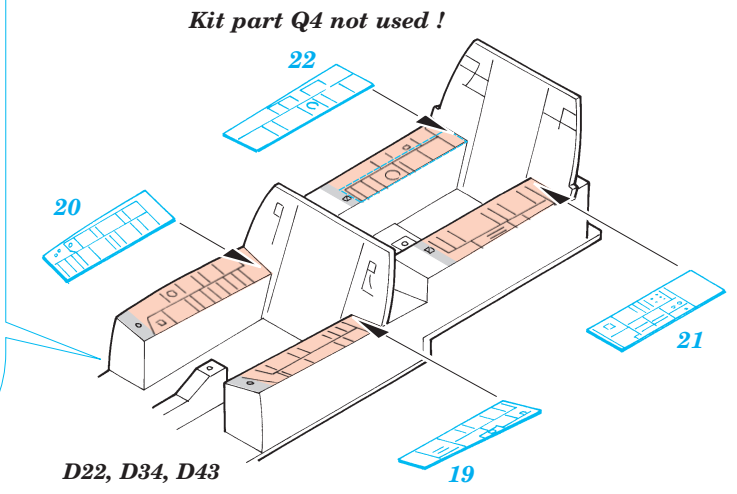
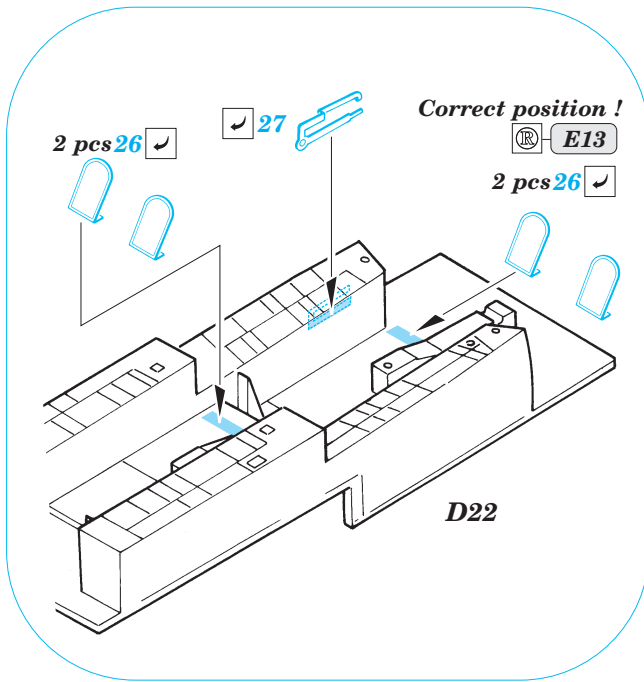

For further detail sets look for **eduard** 49 014 (Green type) and 49 015 (Grey type) F-4 MB Mk.7 ejection seat (not included in this set)

