



*Lolita Stigee*

--- **eduard** *Art*

# Dawn Patrol

SPAD XIII & Fokker D.VII 1/48 scale plastic kit

INSTRUCTION SHEET

**eduard**

#11102X

#11102X - NAVI

ATTENTION



UPOZORNĚNÍ



ACHTUNG



ATTENTION



注意



Carefully read instruction sheet before assembling. When you use glue or paint, do not use near open flame and use in well ventilated room. Keep out of reach of small children. Children must not be allowed to suck any part, or pull vinyl bag over the head.



Před započatím stavby si pečlivě prostudujte stavební návod. Při používání barev a lepidel pracujte v dobře větrané místnosti. Lepidla ani barvy nepoužívejte v blízkosti otevřeného ohně. Model není určen malým dětem, mohlo by dojít k požití drobných dílů.

INSTRUCTION SIGNS \* INSTR. SYMBOL \* INSTRUKTION SINNBILDEN \* SYMBOLES \* 記号の説明

OPTIONAL  
VOLBABEND  
OHNOUTOPEN HOLE  
VYVRTAT OTVORSYMMETRICAL ASSEMBLY  
SYMETRICKÁ MONTÁŽREMOVE  
ODŘÍZNOUTREVERSE SIDE  
OTOČITAPPLY EDUARD MASK  
AND PAINT  
POUŽÍT EDUARD MASK  
NABARVIT

PARTS



DÍLY



TEILE



PIÈCES



部品

# Fokker D.VII

## PLASTIC PARTS

A&gt;

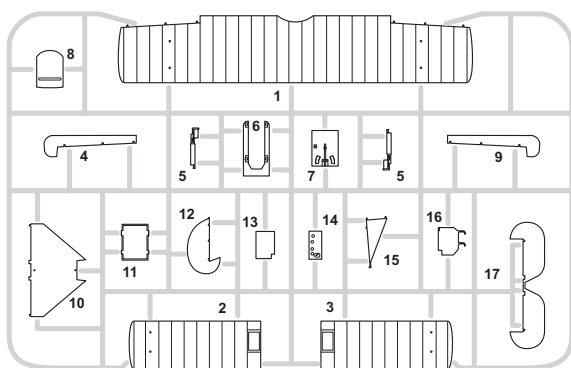

B&gt;

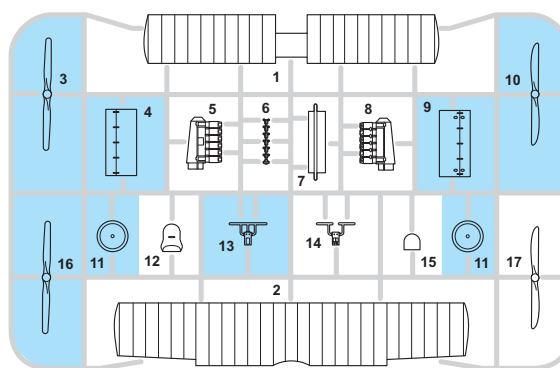
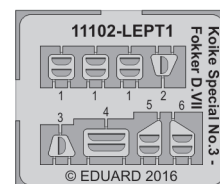
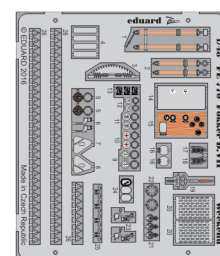
PE - PHOTO ETCHED  
DETAIL PARTS

C&gt;

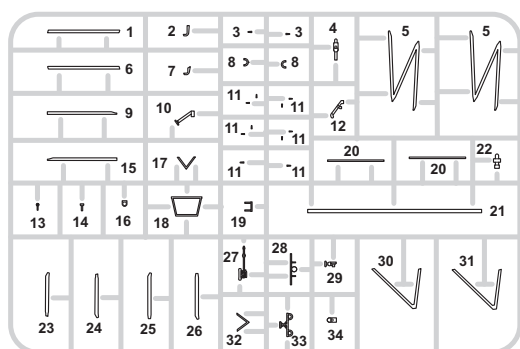

E&gt;

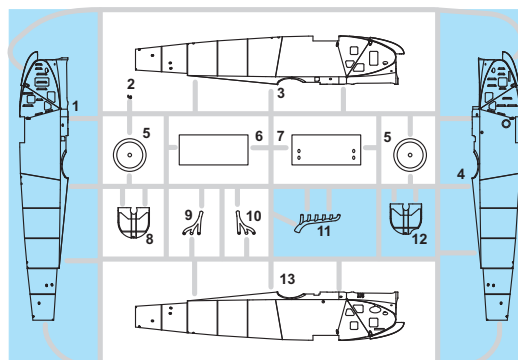
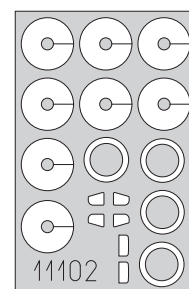
eduard  
MASK

-Parts not for use. -Teile werden nicht verwendet. -Pièces à ne pas utiliser. -Tyto díly nepoužívejte při stavbě. - 使用しない部品

COLOURS



BARVY



FARBEN



PEINTURE



色

GSI Creos (GUNZE)		
AQUEOUS	Mr.COLOR	
H 3	C3	RED
H 8	C8	SILVER
H 11	C62	FLAT WHITE
H 12	C33	FLAT BLACK
H 37	C43	WOOD BROWN
H 47	C41	RED BROWN
H 53	C13	NEUTRAL GRAY
H 76	C61	BURNT IRON

AQUEOUS	Mr.COLOR	
H 77	C137	TIRE BLACK
H 85	C45	SAIL COLOR
H 423	C123	DARK GREEN
Mr.METAL COLOR		
	MC212	IRON
	MC219	BRASS
Mr.COLOR SUPER METALLIC		
	SM04	SUPET STAINLESS

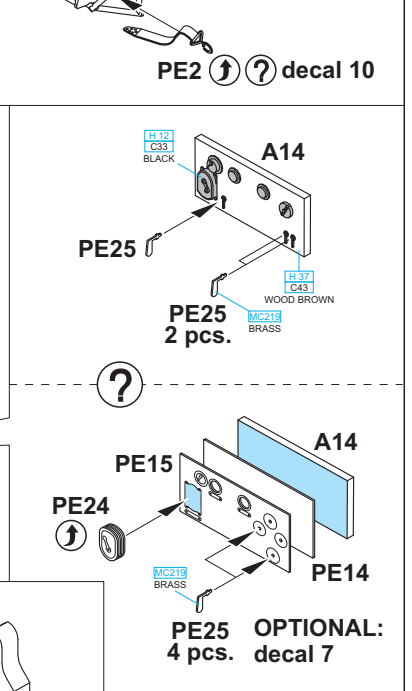
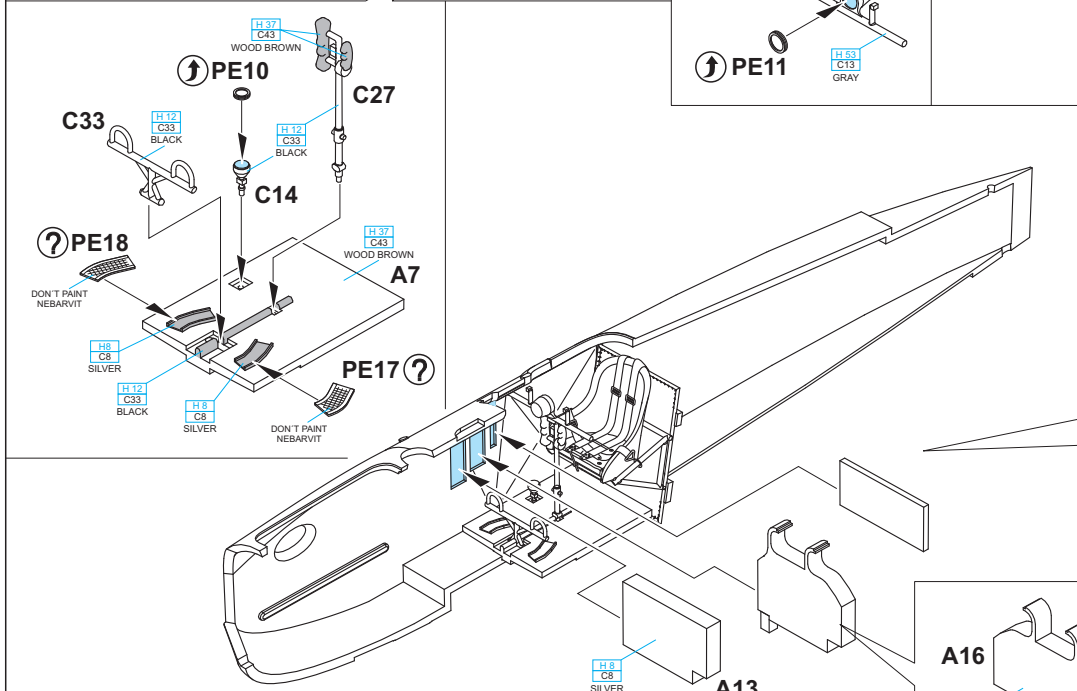
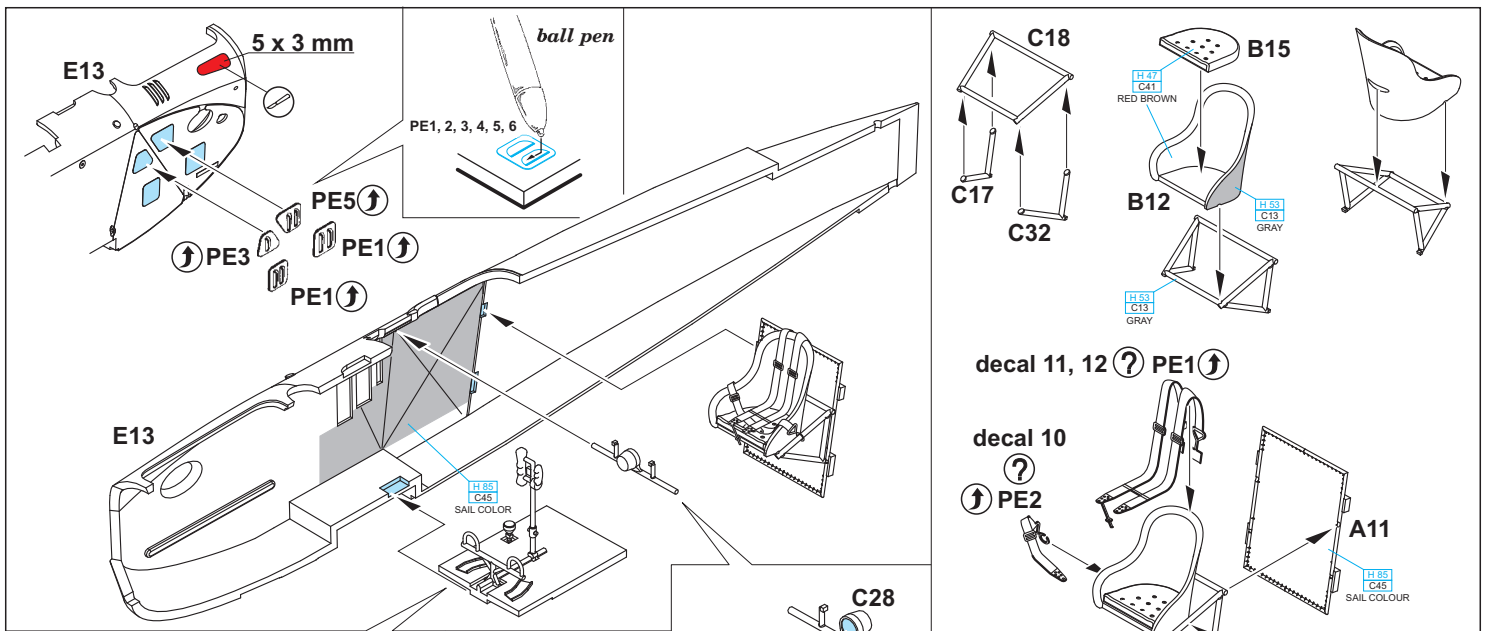

Mercedes D.IIIa engine installation. Art by Mark Miller.  
Instalace motoru Mercedes D.III. Obraz od Marka Millera.

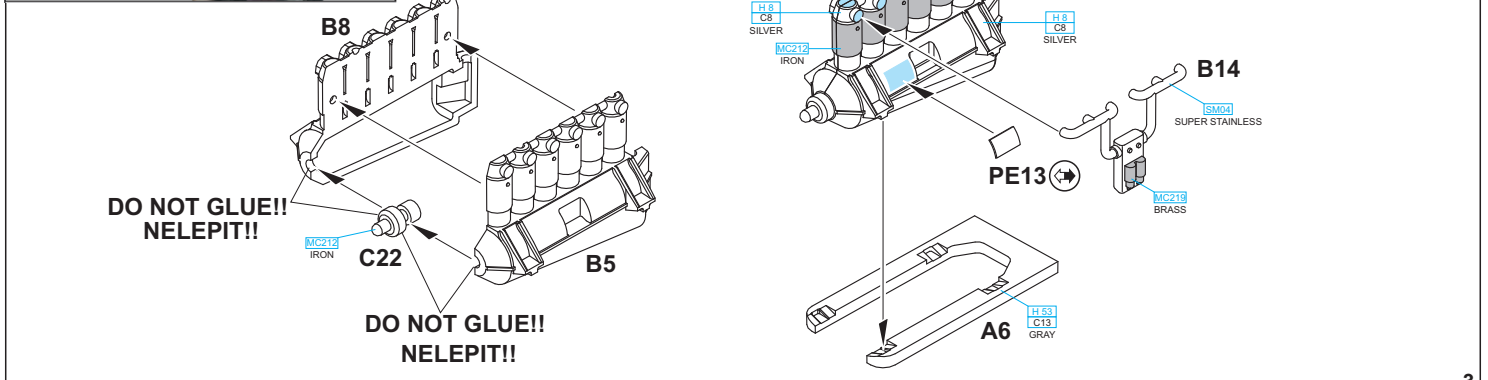
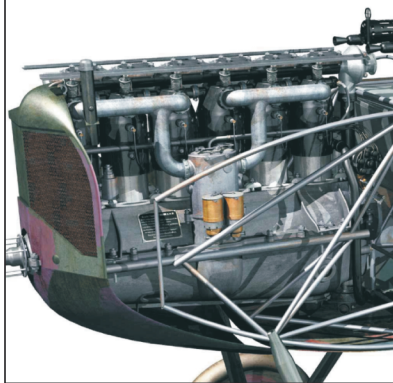

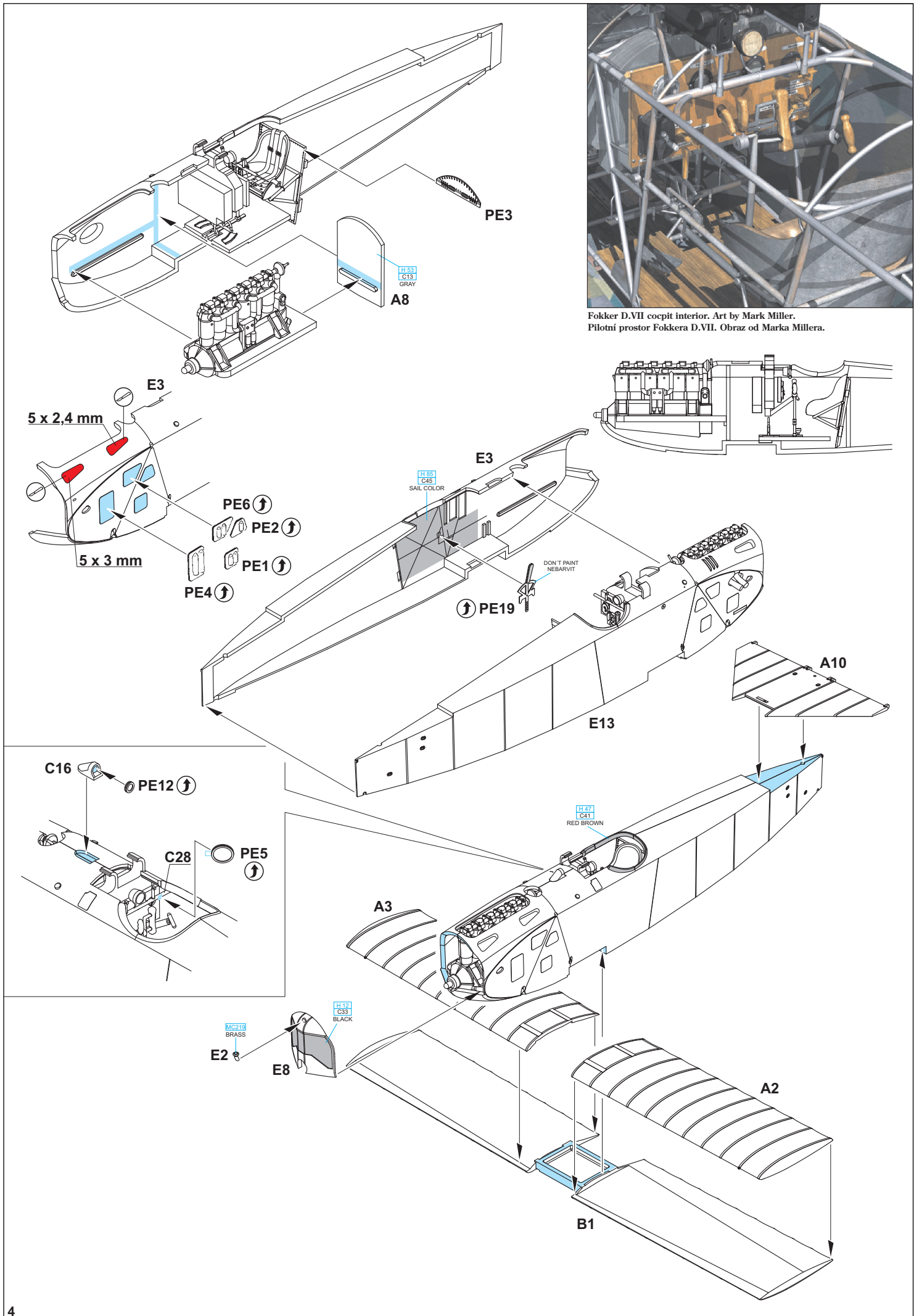

Fokker D.VII copcit interior. Art by Mark Miller.  
 Pilotni prostor Fokkera D.VII. Obraz od Marka Millera.

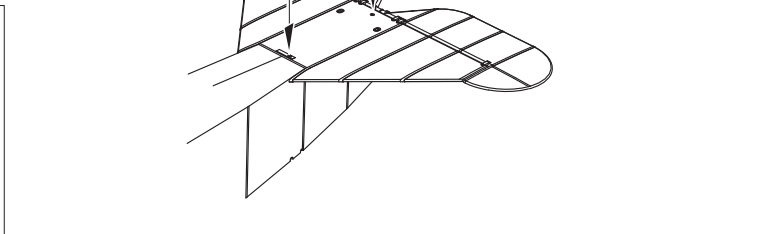
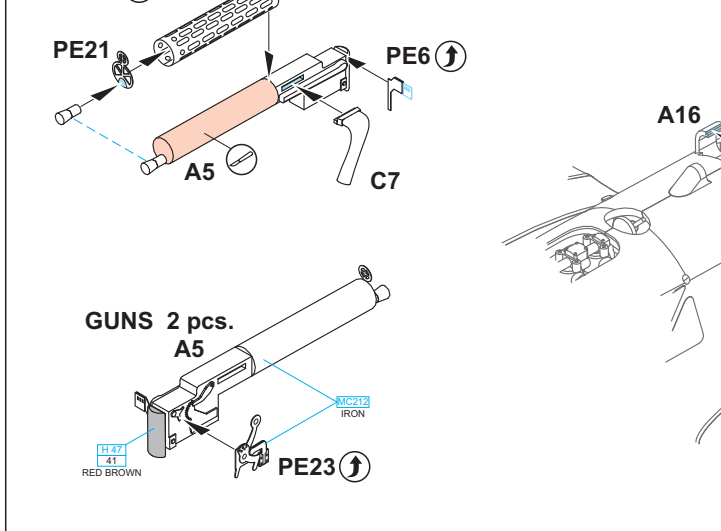
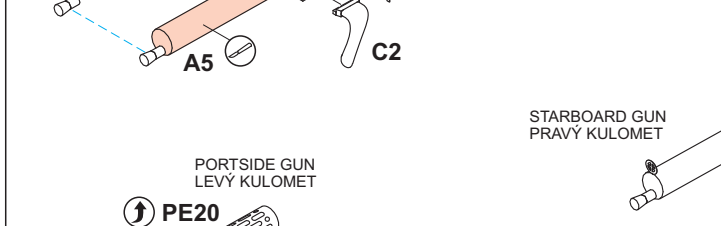
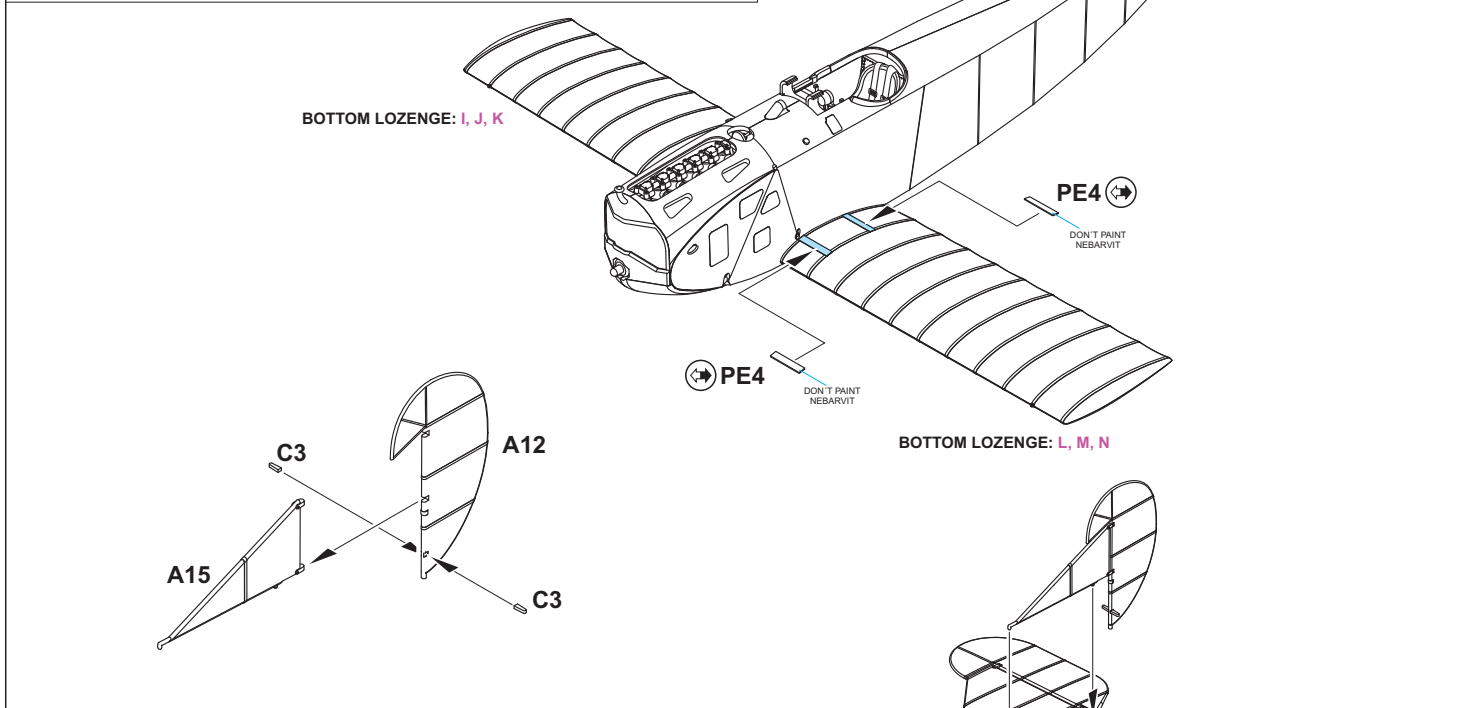
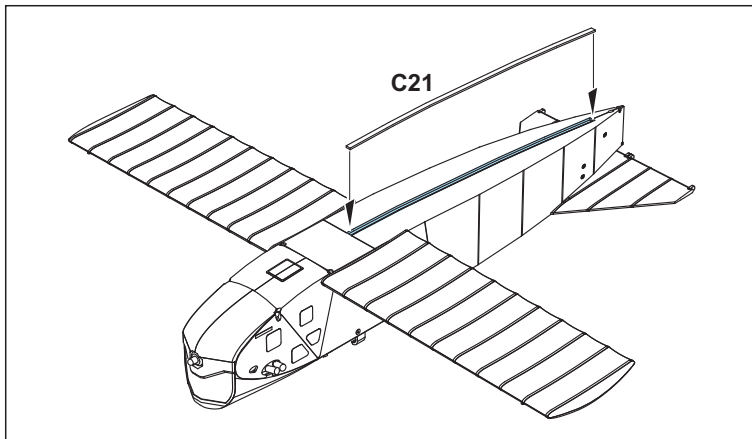

Dashboard & machine gun instalation. Art by Mark Miller. Palubní deska a kulometry. Obraz od Marka Millera.

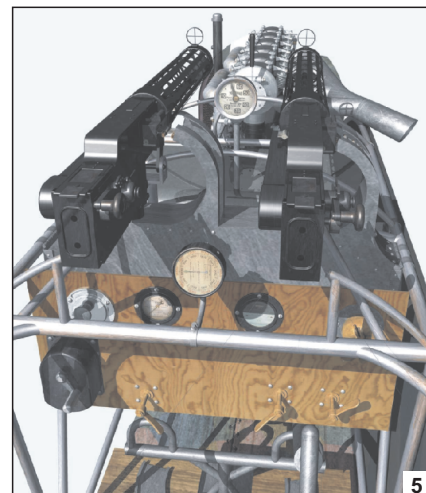

APPLY LOZENGE DECAL IN THIS STEP  
V TOMTO KROKU NANESTE OBTISKY LOZENGE

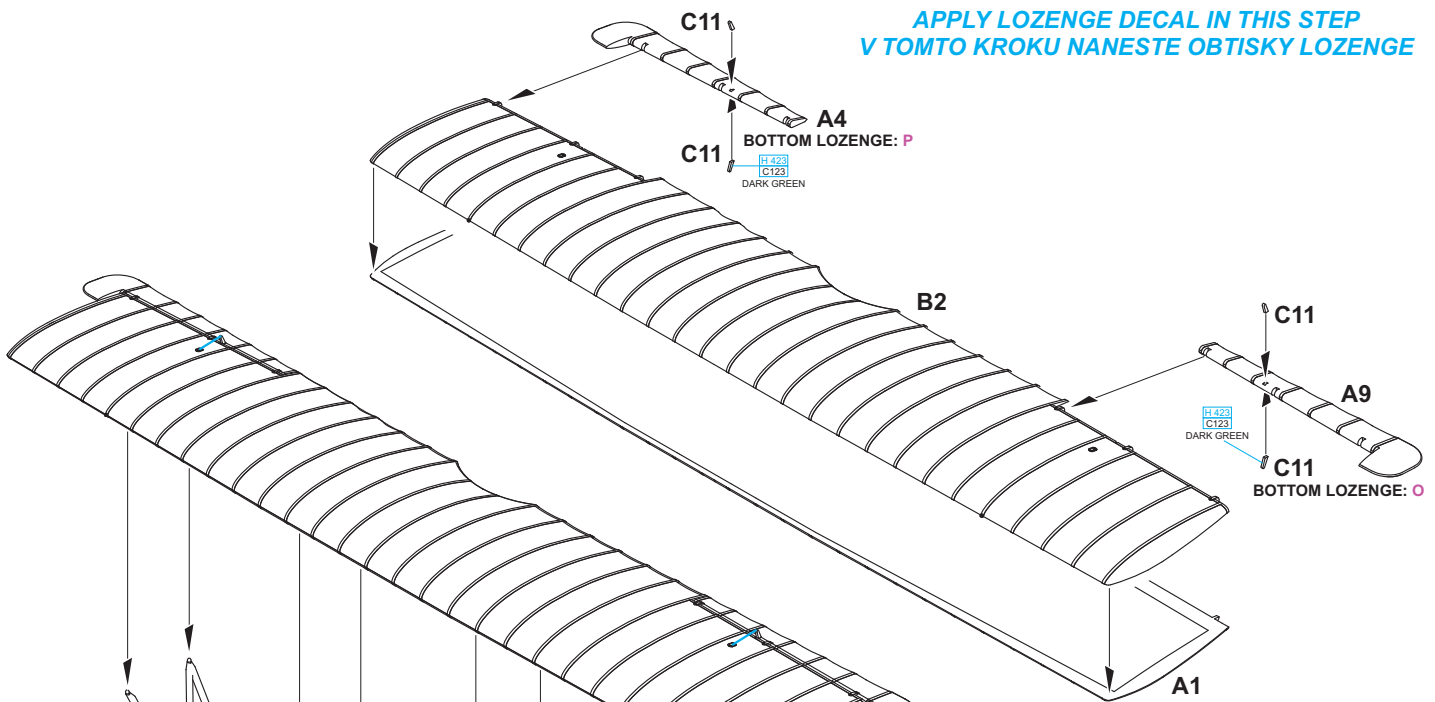

**BOTTOM LOZENGE: A, B, C, D, E, F, G, H**  
RIB STRIPES AND COMPLETE LOZENGE DECAL  
APPLICATION - SEE PAGE 7  
PRO APLIKACI PÁSKŮ NA ŽEBRA A KOMPLETNÍCH  
LOZENGOVÝCH OBTISKŮ PROSTUDUJTE str. 7

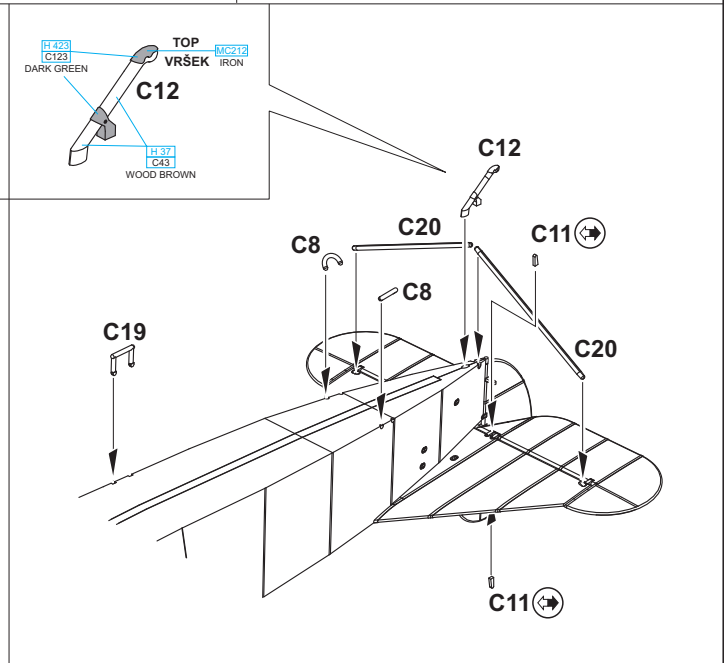
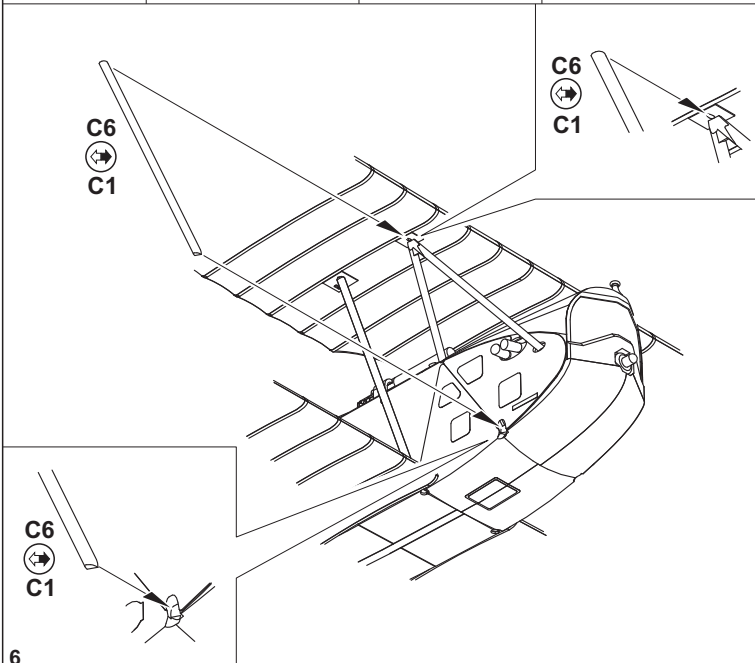
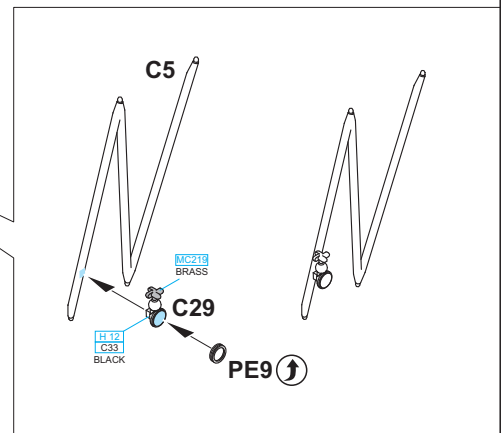
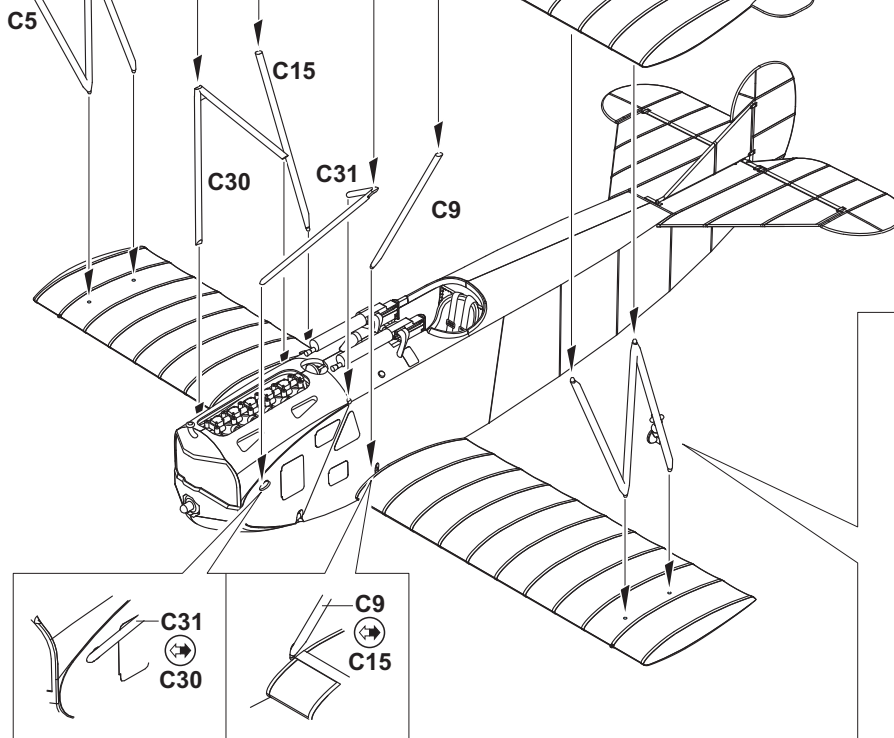

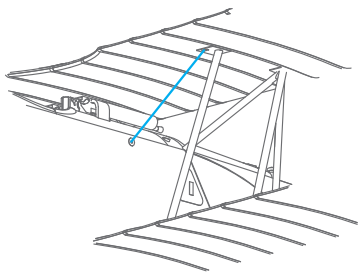
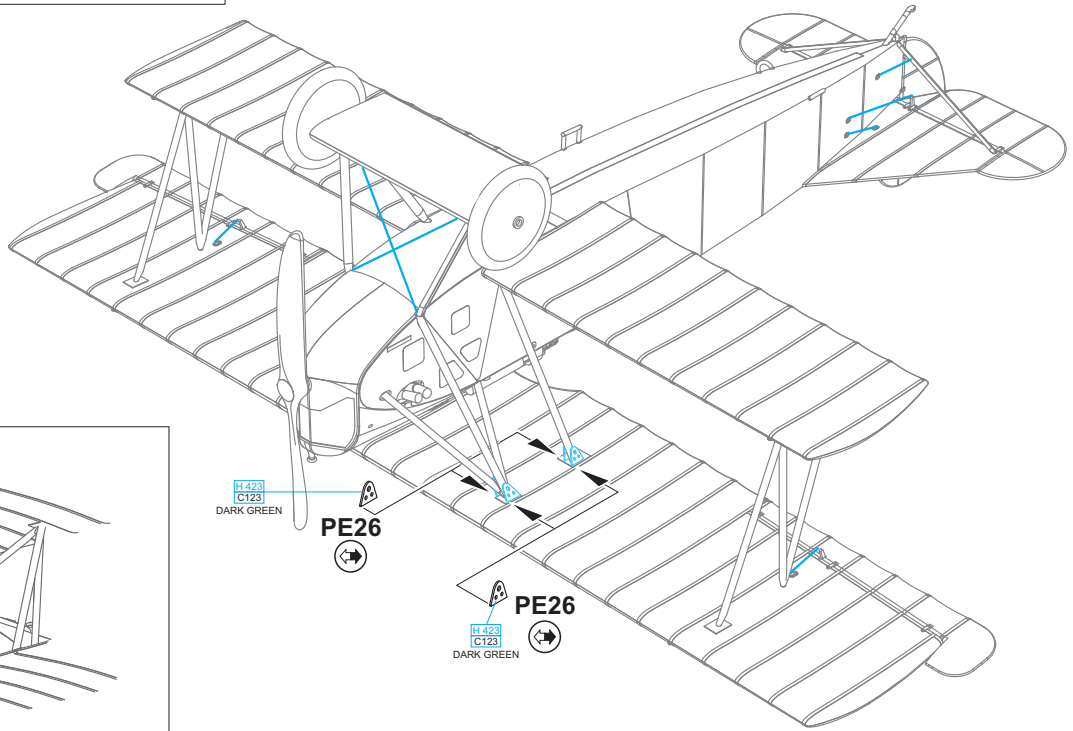
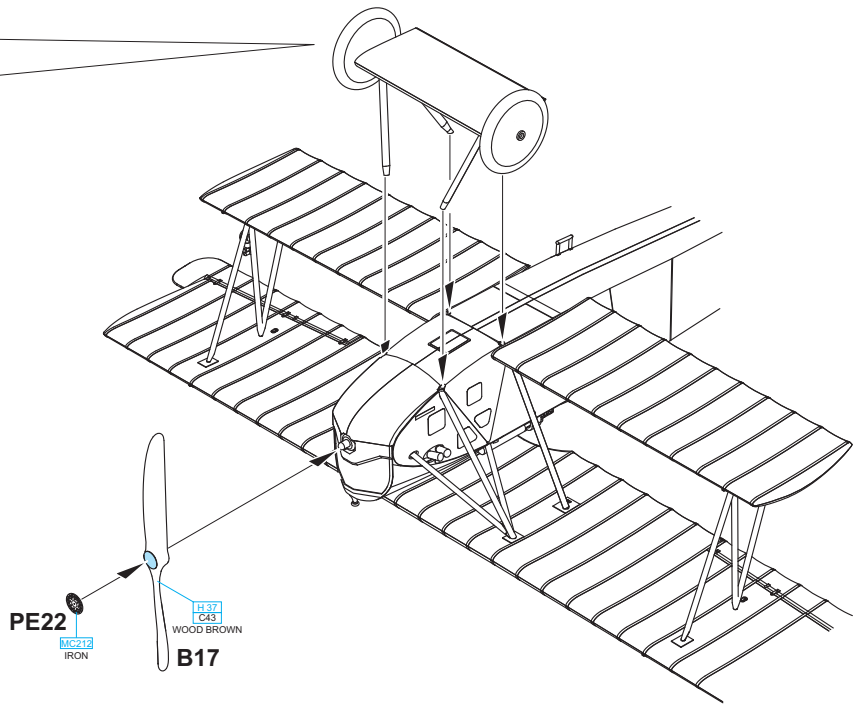
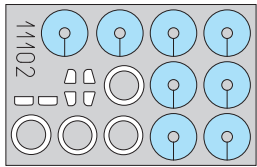
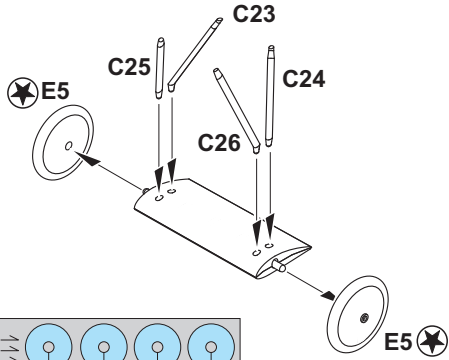
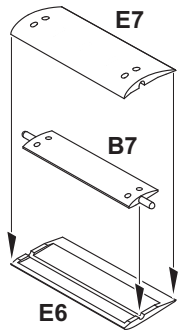

# PORTY

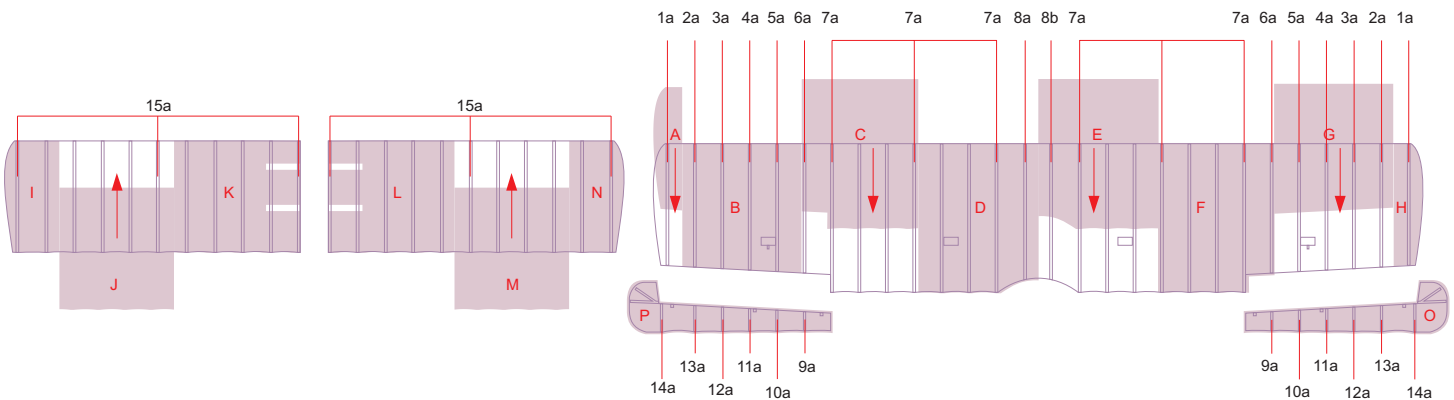

# A Fokker D.VII (Alb), Lt. d. R. Günther von Büren, Jasta 18, Montingen, září 1918

Na tomto stroji létal poručík v záloze Günther von Büren, rodák z Berlína - Charlottenburgu. Nejdříve nastoupil k pozemním jednotkám, konkrétně k 2. Königlich Sächsischen Ulanen-Regimentu Nr. 18. Až v létě 1918 působil u Fliegerabteilung 31 a od srpna pak u Jasta 18. Tato jednotka byla nazývána Raben Staffel, podle svého velitele Augusta Rabena. Kresbu havrana (něm. der Raben) měly letouny Staffel namalovány v různých podobách na trupech. Přední část letounu Günthera von Büren je natřena červenou barvou, zadní pak bílou. Z dostupných materiálů není zřejmé, zda plátno na spodní ploše křídel zůstalo s potiskem lozence, nebo zda bylo také natřeno červenou barvou.

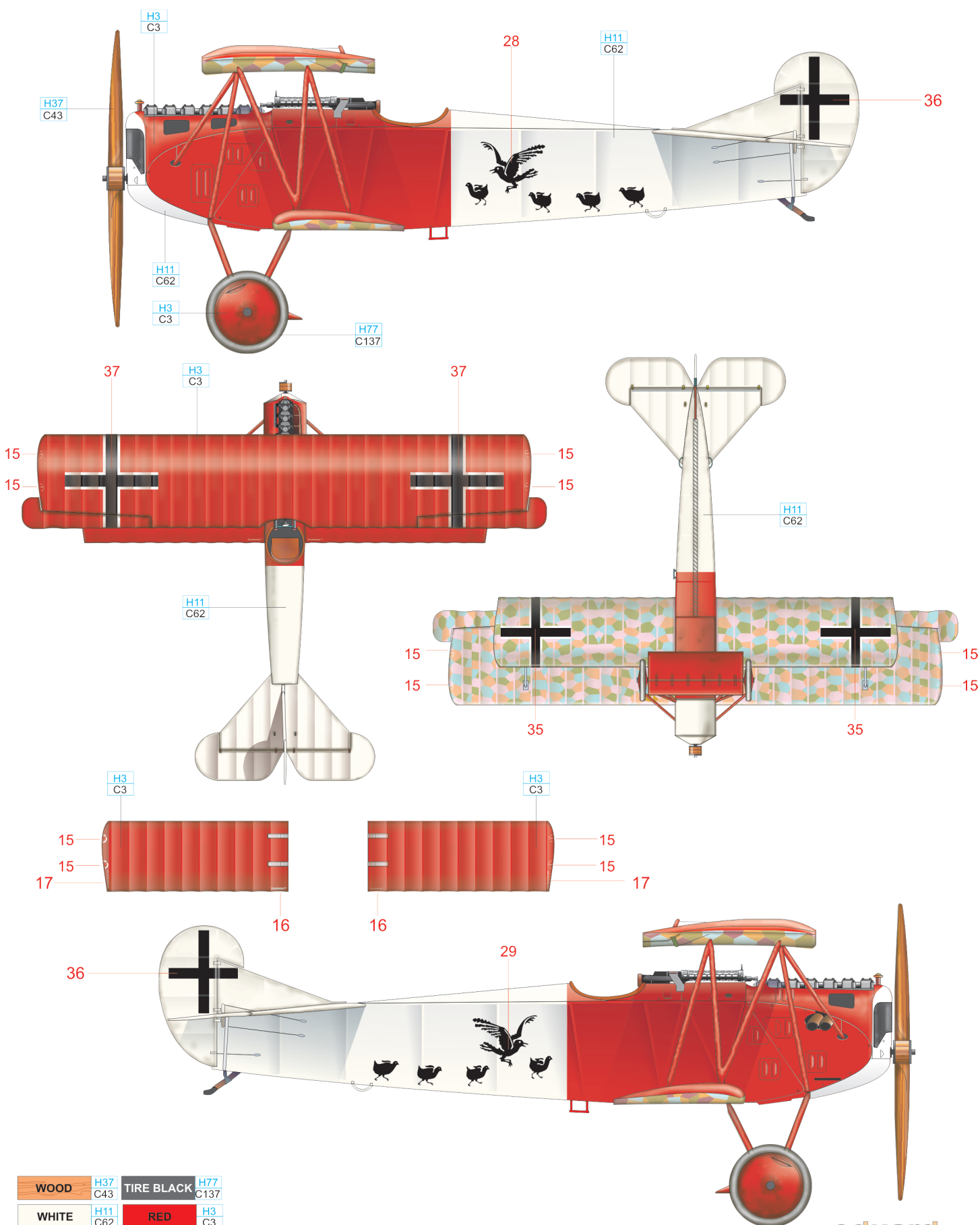



ATTENTION



UPOZORNĚNÍ



ACHTUNG



ATTENTION



注意



Carefully read instruction sheet before assembling. When you use glue or paint, do not use near open flame and use in well ventilated room. Keep out of reach of small children. Children must not be allowed to suck any part, or pull vinyl bag over the head.



Před započítím stavby si pečlivě prostudujte stavební návod. Při používání barev a lepidel pracujte v dobře větrané místnosti. Lepidla ani barvy nepoužívejte v blízkosti otevřeného ohně. Model není určen malým dětem, mohlo by dojít k požití drobných dílů.

INSTRUCTION SIGNS



INSTR. SYMBOLY



INSTRUKTION SINNBILDEN



SYMBOLES

記号の説明

OPTIONAL  
VOLBABEND  
OHNOUTOPEN HOLE  
VYVRTAT OTVORSYMETRICAL ASSEMBLY  
SYMETRICKÁ MONTÁŽREMOVE  
ODŘÍZNOUTREVERSE SIDE  
OTOČITAPPLY EDUARD MASK  
AND PAINT  
POUŽÍT EDUARD MASK  
NABARVIT

PARTS



DÍLY



TEILE



PIÈCES



部品

# SPAD XIII

PLASTIC PARTS

B&gt;

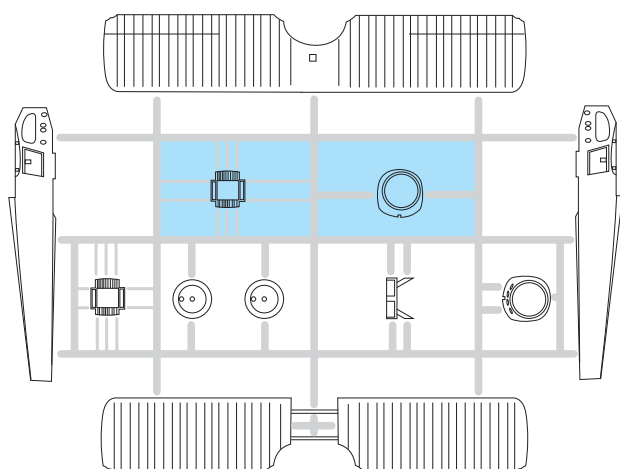

C&gt;

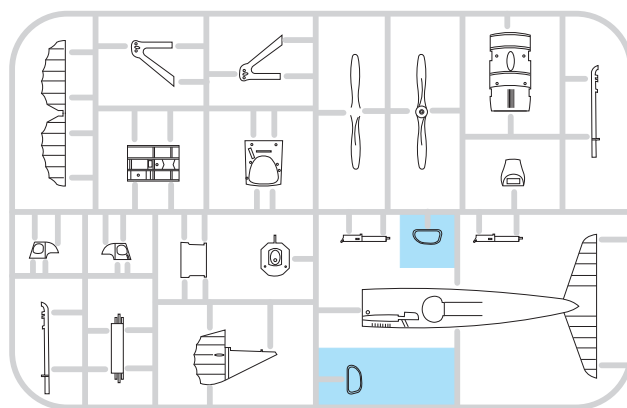

D&gt;

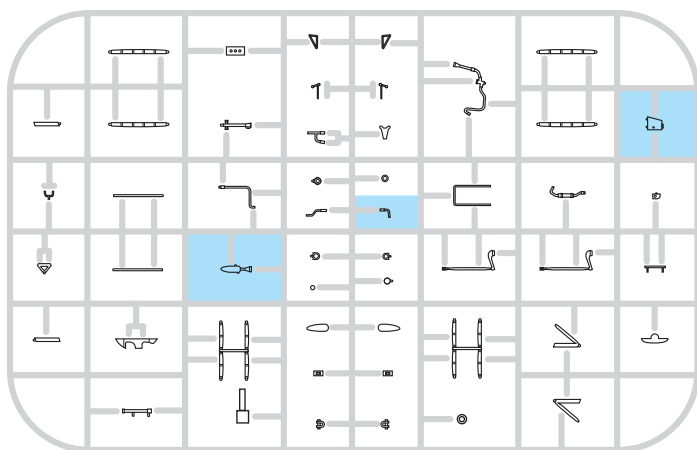

E&gt;

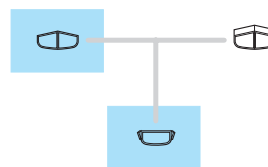

## PE - PHOTO ETCHED DETAIL PARTS

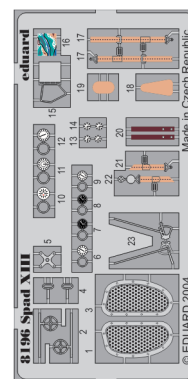

-Parts not for use. -Teile werden nicht verwendet. -Pièces à ne pas utiliser. -Tyto díly nepoužívejte při stavbě. - 使用しない部品

COLOURS



BARVY



FARBEN



PEINTURE



色

GSI Creos (GUNZE)		
AQUEOUS	Mr.COLOR	
<a href="#">H 5</a>	<a href="#">C5</a>	BLUE
<a href="#">H 12</a>	<a href="#">C33</a>	FLAT BLACK
<a href="#">H 37</a>	<a href="#">C43</a>	WOOD BROWN
<a href="#">H 47</a>	<a href="#">C41</a>	RED BROWN
<a href="#">H 51</a>	<a href="#">C11</a>	LIGHT GRAY
<a href="#">H 53</a>	<a href="#">C13</a>	NEUTRAL GRAY
<a href="#">H 64</a>	<a href="#">C17</a>	BLACK GREEN
<a href="#">H 66</a>	<a href="#">C119</a>	SANDY BROWN

GSI Creos (GUNZE)		
AQUEOUS	Mr.COLOR	
<a href="#">H 72</a>	<a href="#">C22</a>	DARK EARTH
<a href="#">H 85</a>	<a href="#">C45</a>	SAIL COLOR
<a href="#">H 303</a>	<a href="#">C303</a>	GREEN
AQUEOUS	Mr.COLOR	
Mr.METAL COLOR		
	<a href="#">MC214</a>	DARK IRON
	<a href="#">MC218</a>	ALUMINIUM
	<a href="#">MC219</a>	BRASS

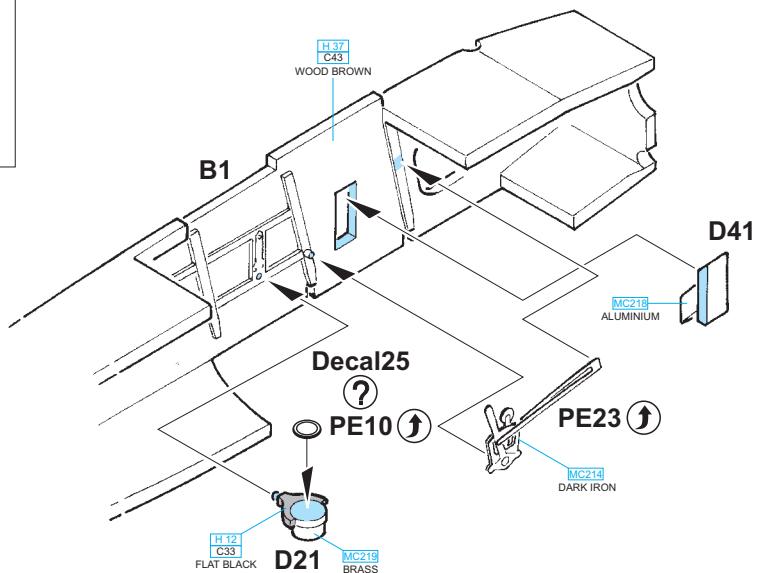
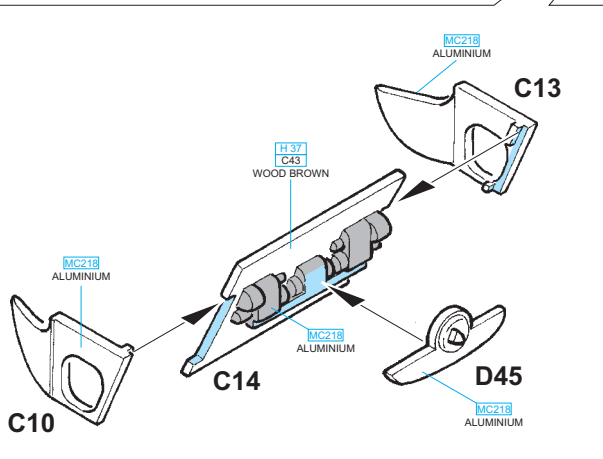
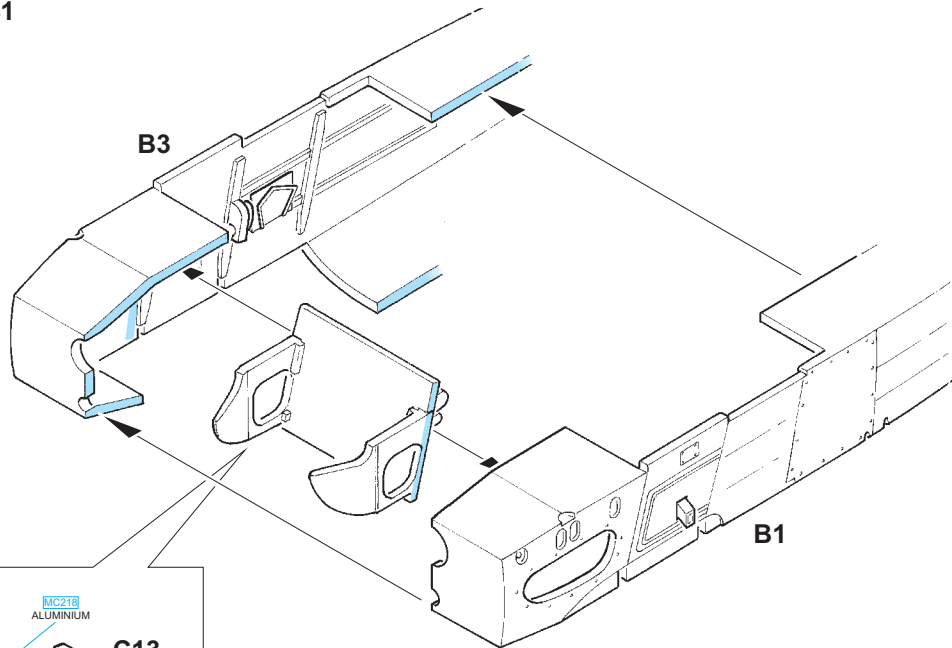
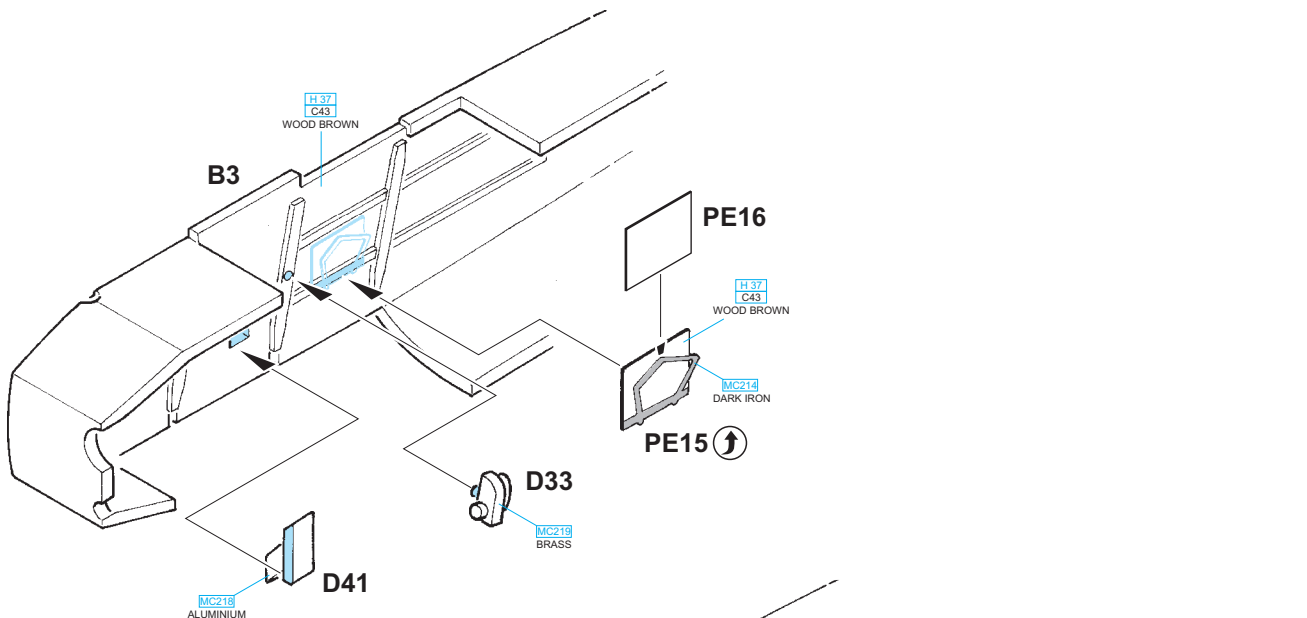

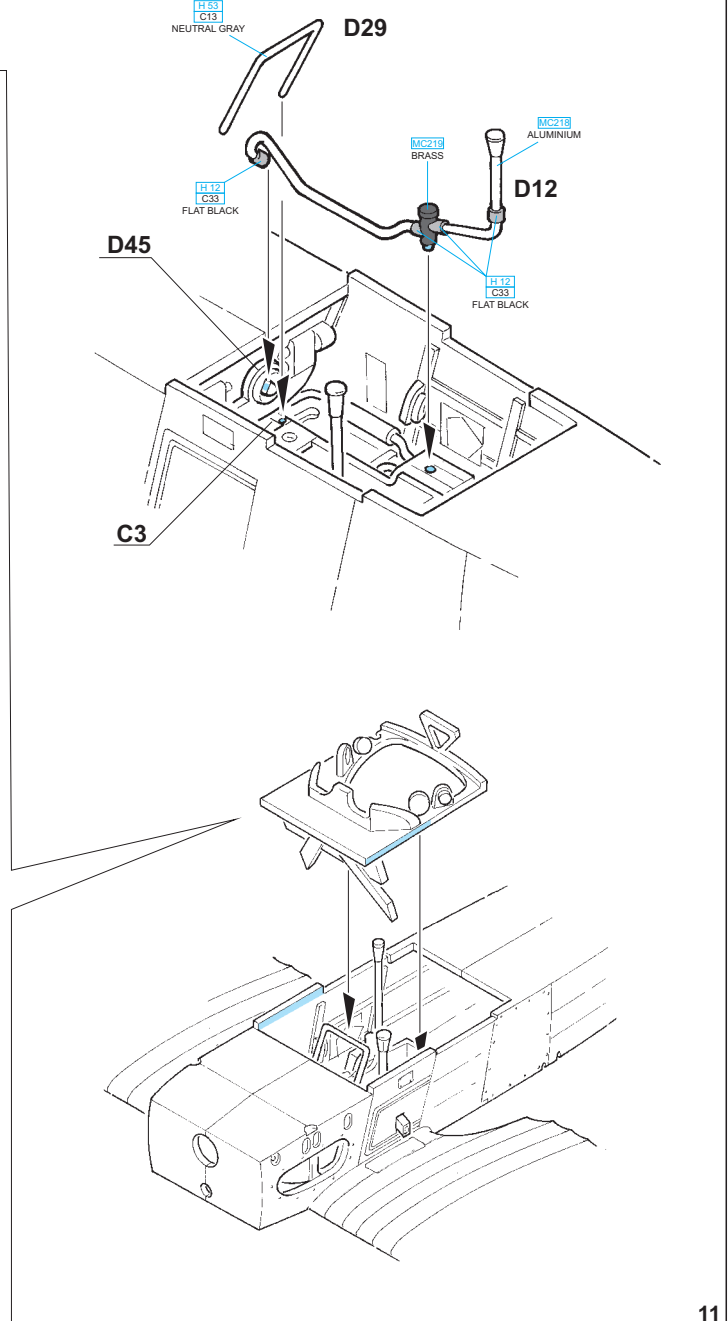
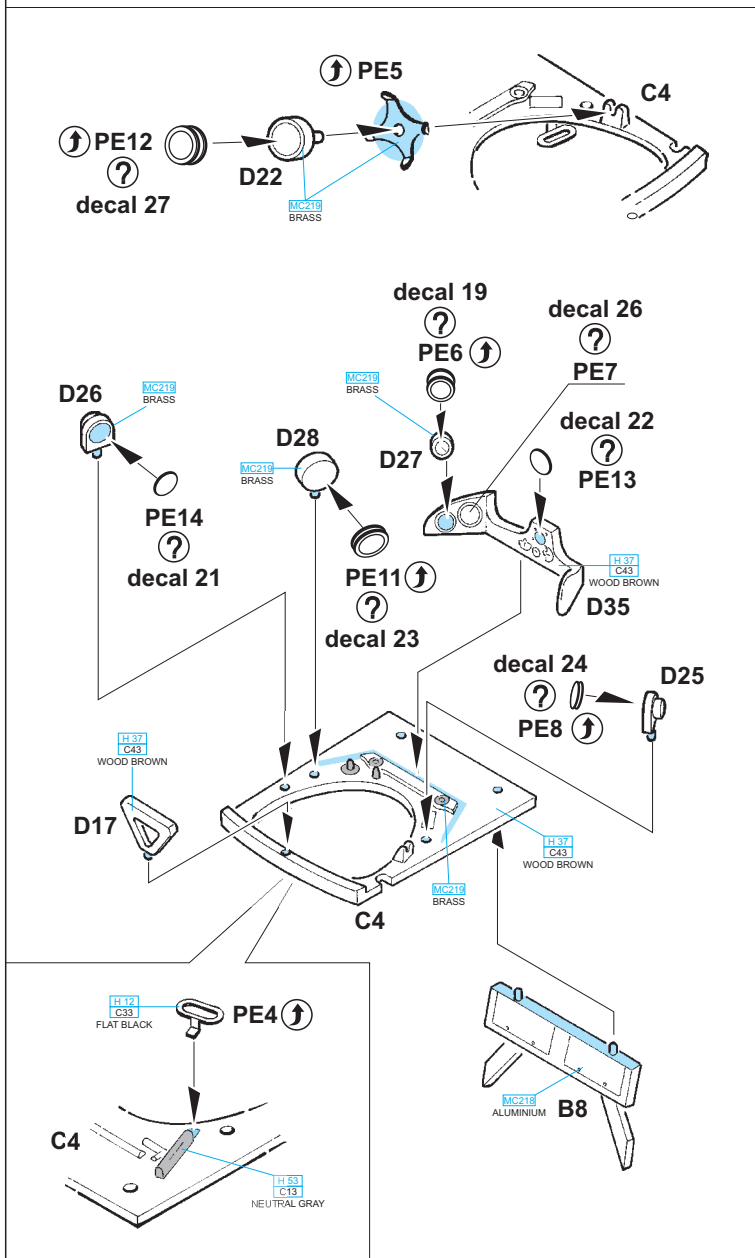
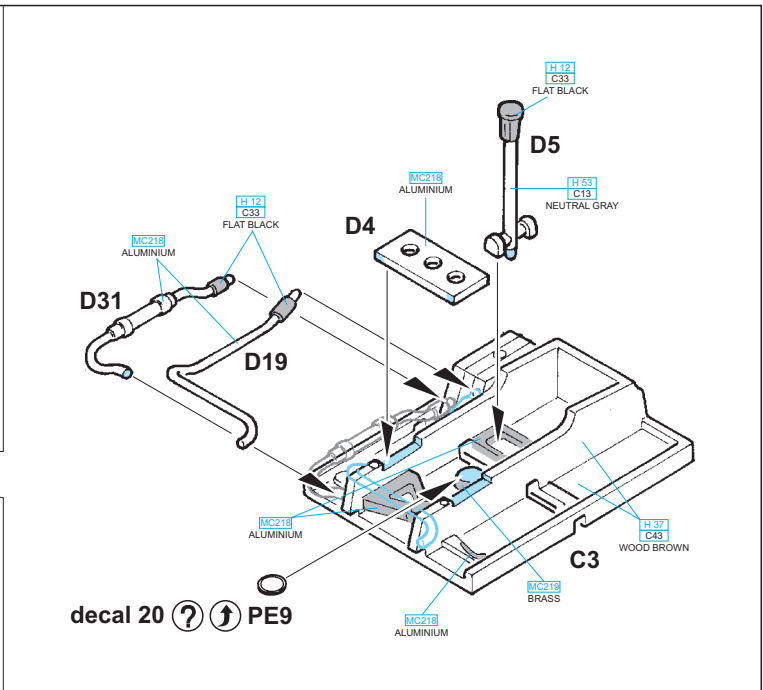
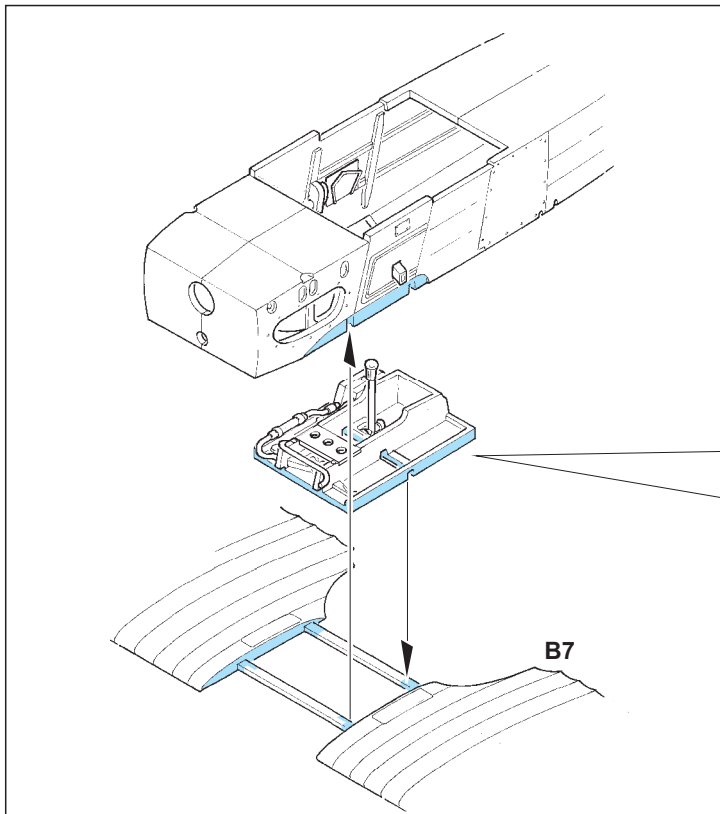

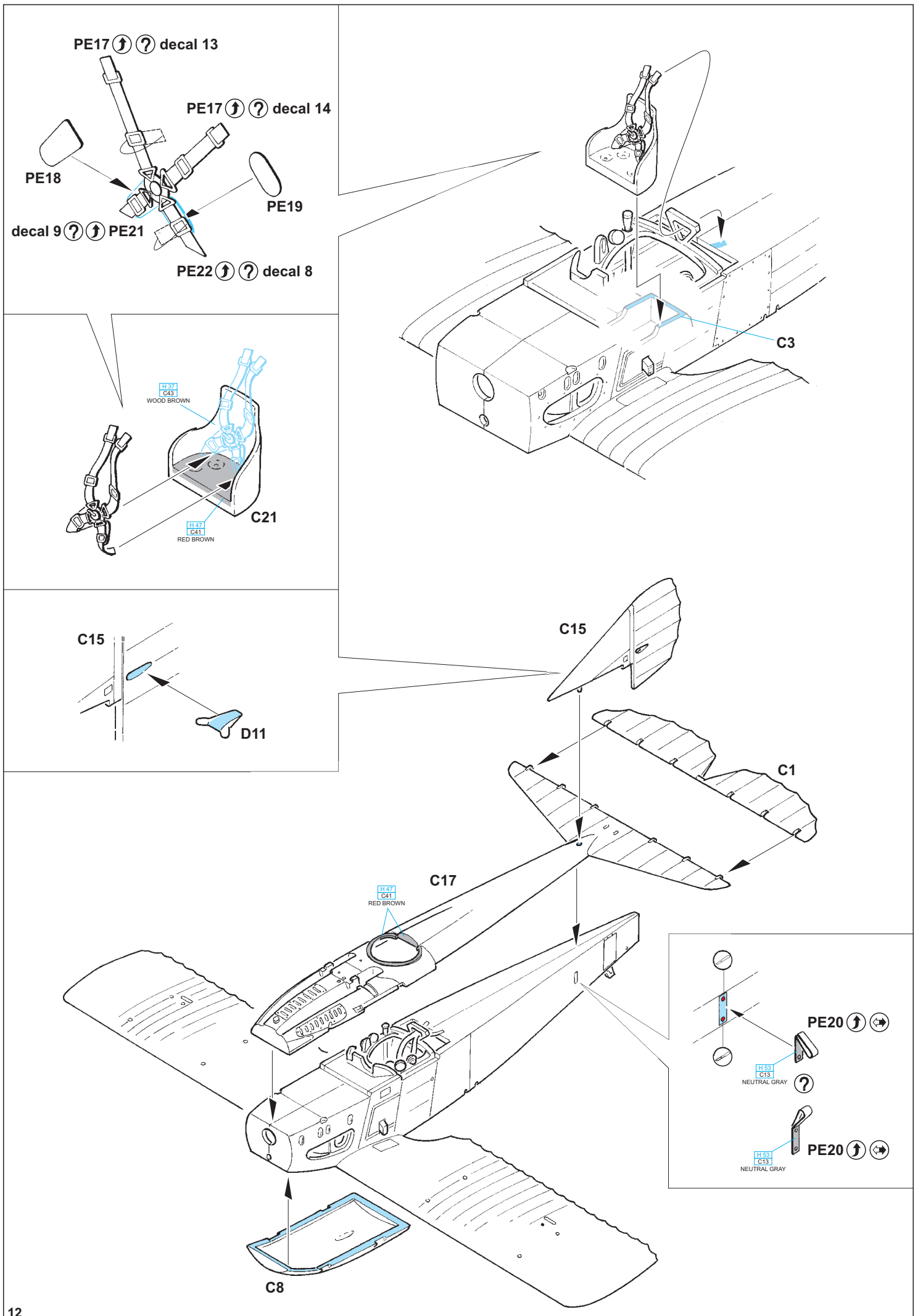

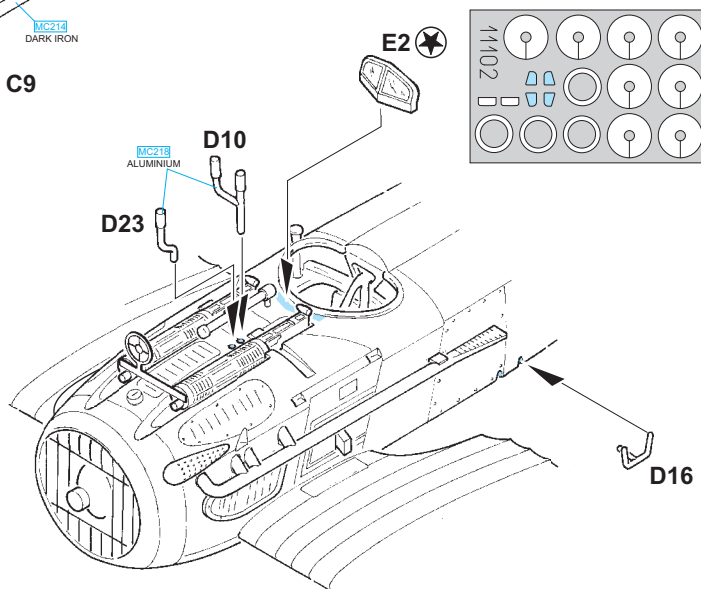
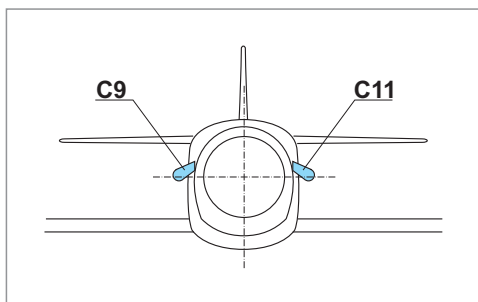
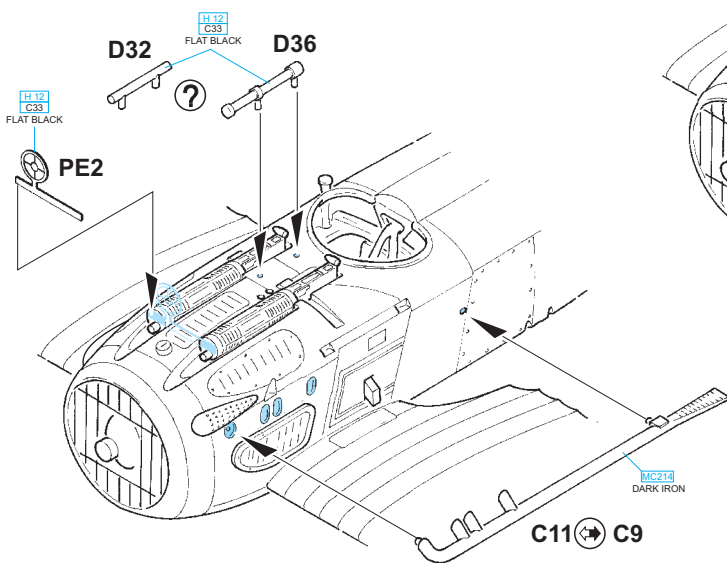
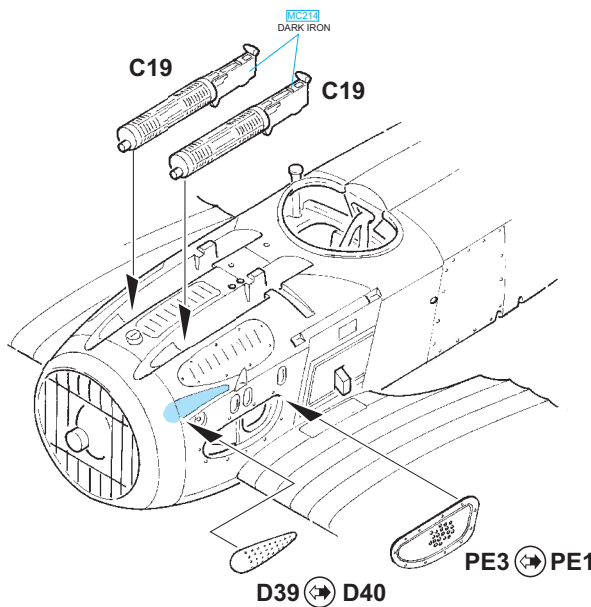
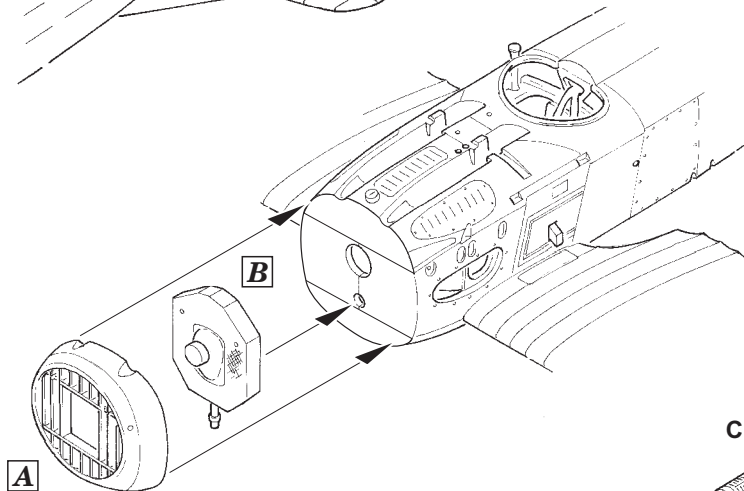
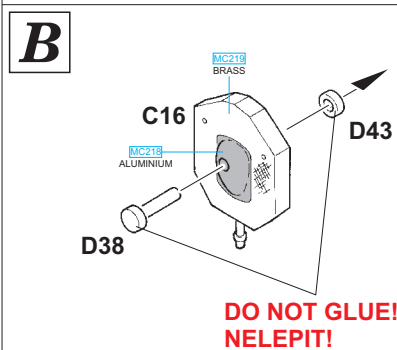
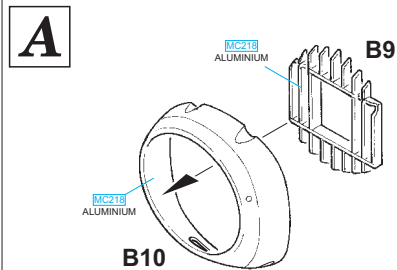
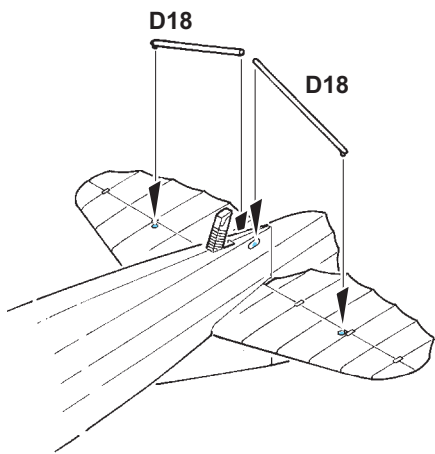

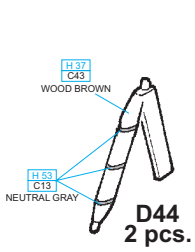

**D44**  
2 pcs.

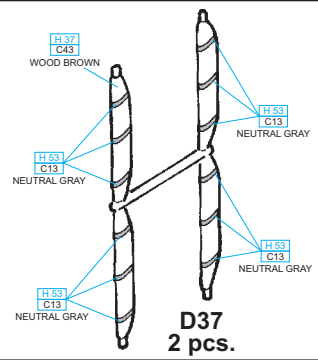

**D37**  
2 pcs.

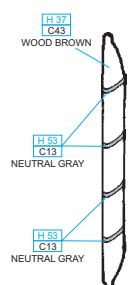

**D2, D3,**  
**D13,**  
**D14**

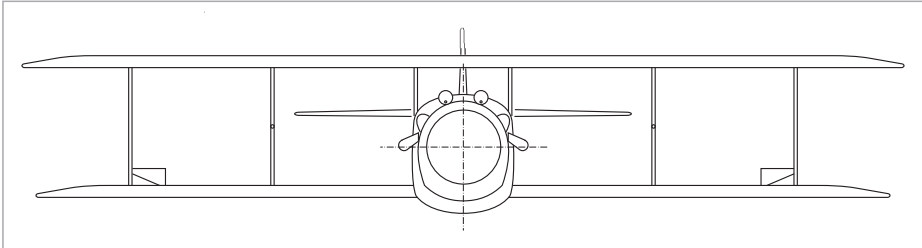
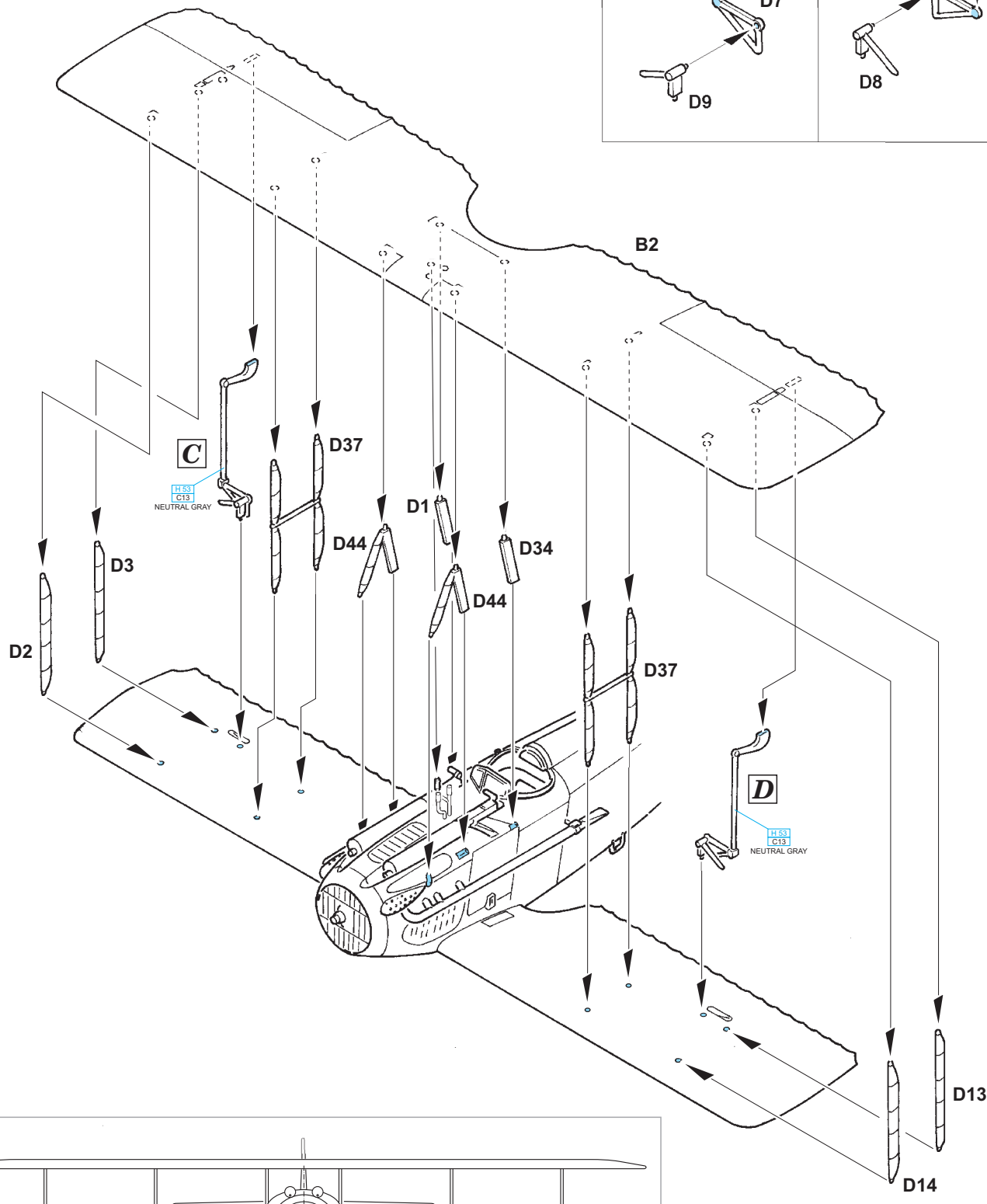
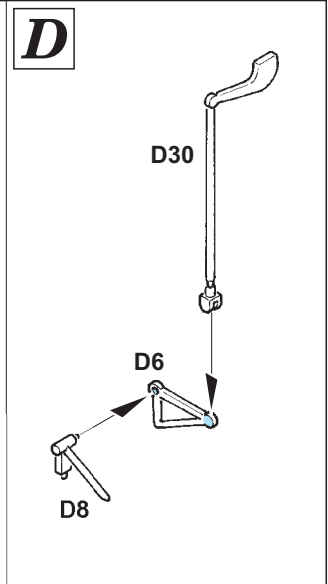
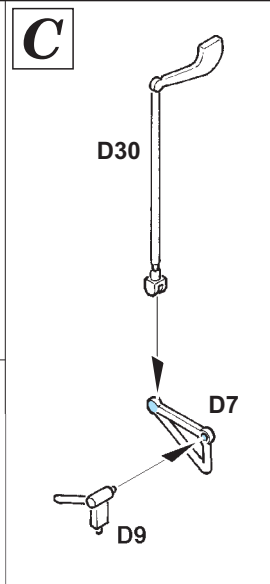

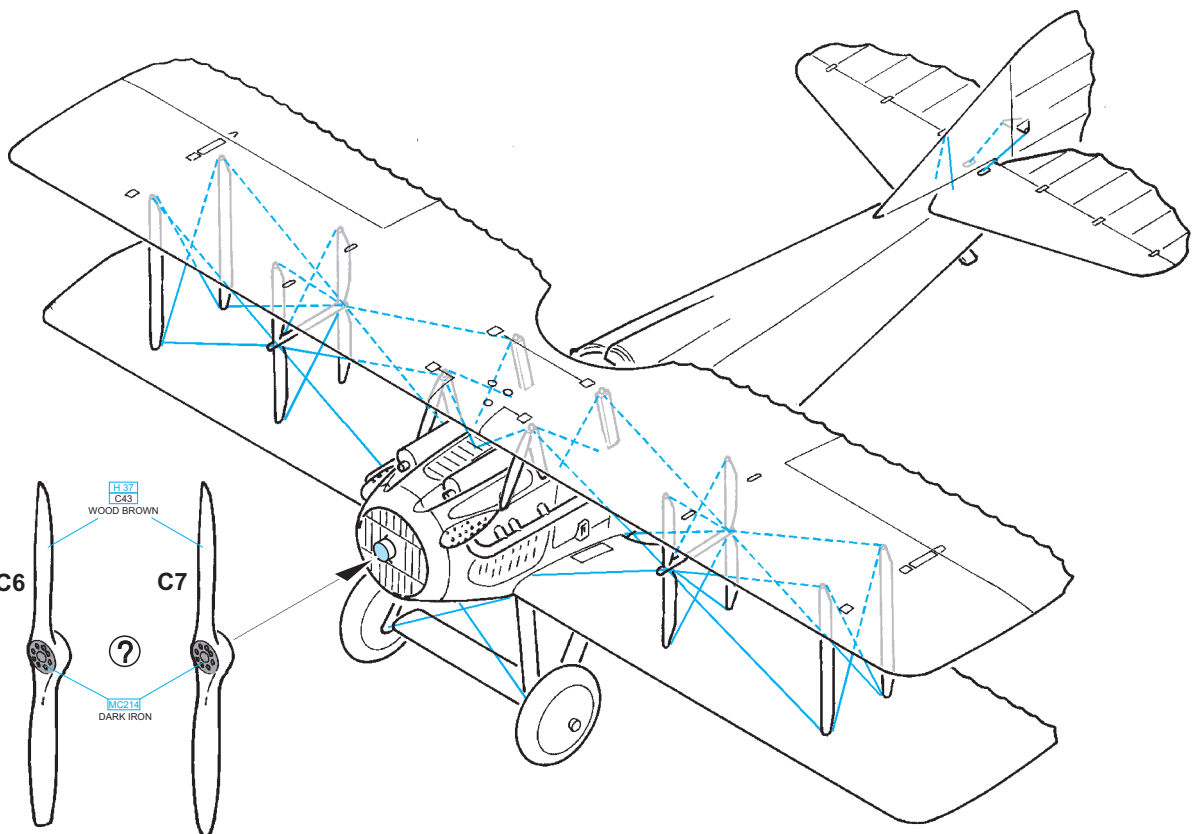
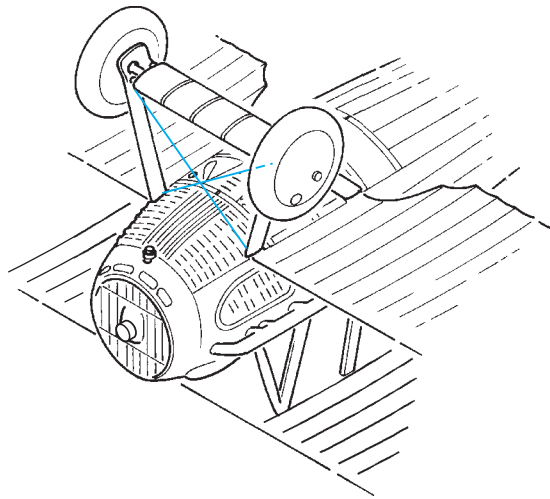
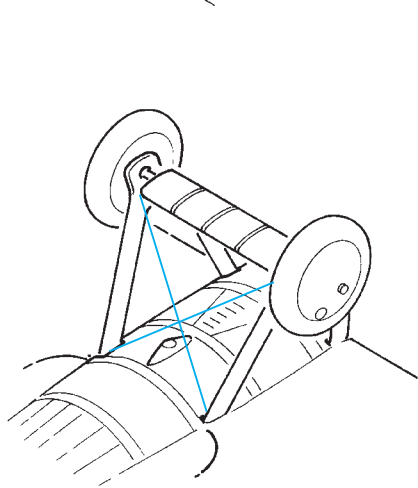
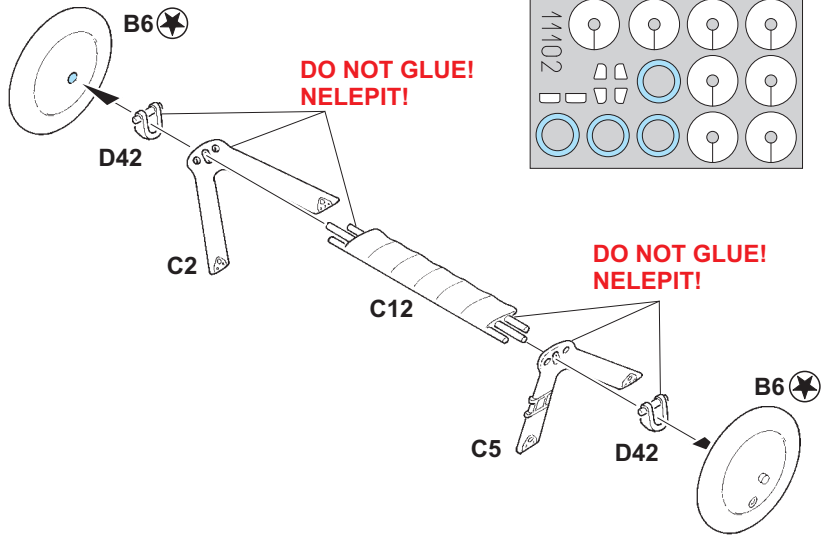
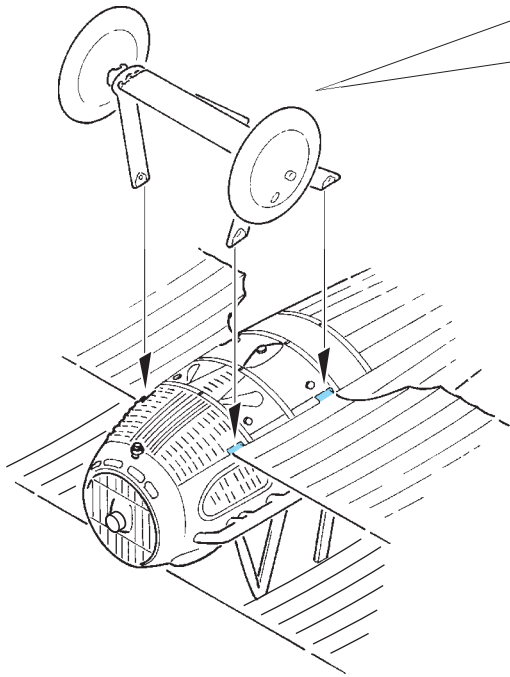

# B SPAD XIII, Lt. Frank Luke Jr., 27th Aero Squadron, září 1918

Jeden ze Spadů XIII, které používalo během září 1918 americké balonové eso Second Lieutenant Frank Luke, pilot 27. Aero Squadron USAS. Všech 18 potvrzených sestřelů, z toho 14 balonů, dosáhl Luke v době mezi 12. a 27. září 1918, kdy nakonec sám padl. Zobrazený Spad nese jedno ze dvou používaných kamuflážních schémat firmy Blériot. Frank Luke byl znám nejen jako vynikající stíhač, ale také jako zcela nedisciplinovaný sólista.

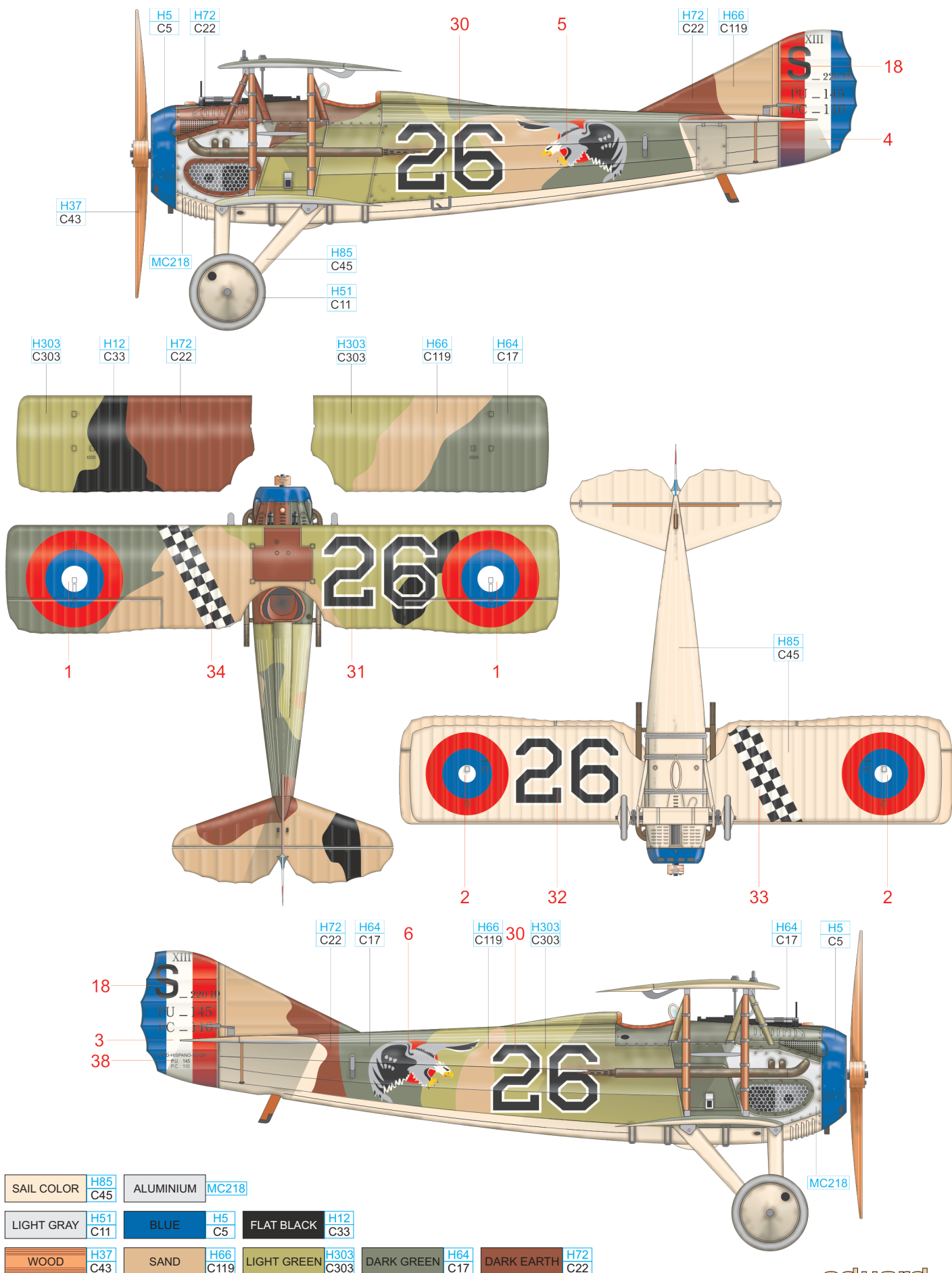

SAIL COLOR	H85 C45	ALUMINIUM	MC218
LIGHT GRAY	H51 C11	BLUE	H5 C5
		FLAT BLACK	H12 C33
WOOD	H37 C43	SAND	H66 C119
		LIGHT GREEN	H303 C303
		DARK GREEN	H64 C17
		DARK EARTH	H72 C22